

sare[®]
GLOBAL
High quality Turkish brand

DATA SHEET



**Short
Stroke**

SDA Series

Double acting
Hydraulic return
50-250 ton capacity
50-75 mm stroke
Totally 12 models



**HYDRAULIC
SYSTEMS FOR
BRIDGE
CONSTRUCTION
AND
REPAIRS**

SDA Series





SDA Series

Double acting, short stroke
 Hydraulic return
 50 - 250 ton capacity
 50 - 75 mm stroke
 Totally 12 models
 700 bar maximum operating pressure

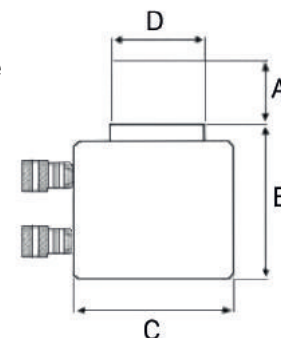

Model No.	Capacity	A	B	C	D	Effective Area	Oil Capacity	Weight
		Stroke	Closed Height	Outside Diameter	Rod Diameter			
	ton	mm	mm	mm	mm	cm ²	cm ³	kg
SDA-505	50	50	130	137	80	70,85	354	15,0
SDA-508		75	155					
SDA-755	75	50	133	157	100	103,82	519	20,0
SDA-758		75	158					
SDA-1005	100	50	138	185	115	143,07	715	27,5
SDA-1008		75	163					
SDA-1505	150	50	145	217	140	213,72	1069	39,5
SDA-1508		75	170					
SDA-2005	200	50	155	247	165	283,40	1417	55,0
SDA-2008		75	180					
SDA-2505	250	50	165	278	185	362,87	1814	76,0
SDA-2508		75	190					

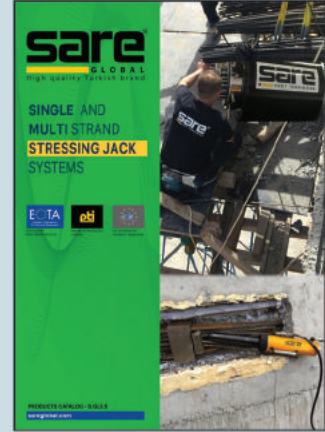
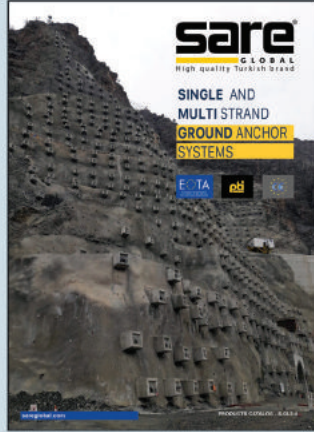
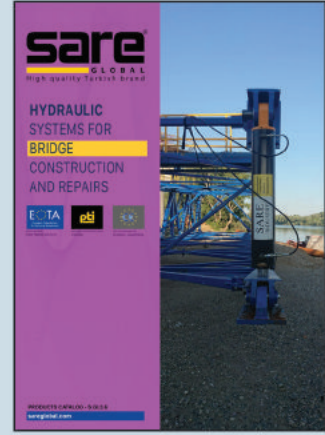

sare[®]
G L O B A L
 High Quality Turkish Brand

Merkez Mah. Çavuşbaşı Cad. No.42 D.5-8 Çekmeköy 34782 İstanbul - Türkiye
 P: +90 216 313 11 13 pbx
 info@sareglobal.com • www.sareglobal.com

