

sare[®]
GLOBAL
High quality Turkish brand

DATA SHEET



SA Series

Single acting
Load return
30-100 ton capacity
100-400 mm stroke
Totally 28 models



**HYDRAULIC
SYSTEMS FOR
BRIDGE
CONSTRUCTION
AND
REPAIRS**

SA Series





SA Series

Single acting
Load return
30 - 100 ton capacity
100 - 400 mm stroke
Totally 28 models
700 bar maximum operating pressure

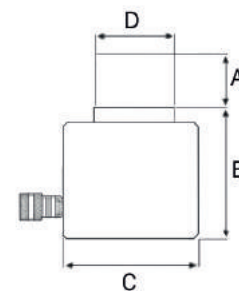

Model No.	Capacity	A	B	C	D	Effective Area	Oil Capacity	Weight
		Stroke	Closed Height	Outside Diameter	Rod Diameter			
	ton	mm	mm	mm	mm	cm ²	cm ³	kg
SA-3010	30	100	215	112	65	44,18	442	16,0
SA-3015		150	265				663	19,5
SA-3020		200	315				884	23,0
SA-3025		250	365				1105	26,5
SA-3030		300	415				1325	30,0
SA-3035		350	465				1546	33,5
SA-3040		400	515				1767	37,0
SA-5010	50	100	220	138	85	70,88	709	25,0
SA-5015		150	270				1063	30,5
SA-5020		200	320				1418	36,0
SA-5025		250	370				1772	41,5
SA-5030		300	420				2126	47,0
SA-5035		350	470				2481	52,5
SA-5040		400	520				2835	58,0
SA-7510	75	100	225	158	105	103,87	1039	33,5
SA-7515		150	275				1558	40,5
SA-7520		200	325				2077	47,5
SA-7525		250	375				2597	54,5
SA-7530		300	425				3116	61,5
SA-7535		350	475				3635	68,5
SA-7540		400	525				4155	75,5
SA-10010	100	100	225	185	120	143,14	1432	45,5
SA-10015		150	275				2147	55,0
SA-10020		200	325				2863	64,5
SA-10025		250	375				3588	74,0
SA-10030		300	425				4294	83,5
SA-10035		350	475				5010	93,0
SA-10040		400	525				5726	102,5

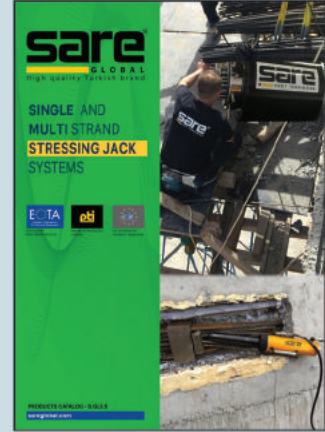
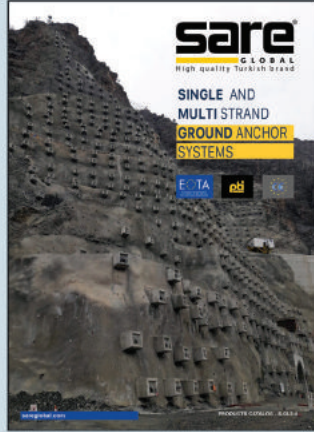
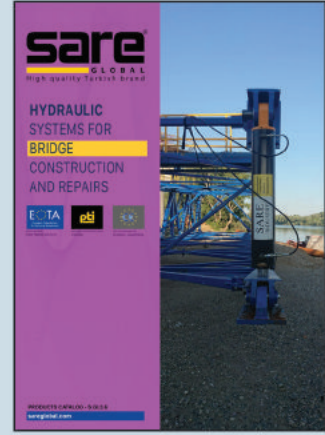

sare[®]
GLOBAL
High Quality Turkish Brand

Merkez Mah. Çavuşbaşı Cad. No.42 D.5-8 Çekmeköy 34782 İstanbul - Türkiye
P: +90 216 313 11 13 pbx
info@sareglobal.com • www.sareglobal.com

