

sare[®]
GLOBAL
High quality Turkish brand

DATA SHEET



**Lock
Nut**

NSA Series

Single acting
Load return
50-500 ton capacity
100-250 mm stroke
Totally 24 models



**HYDRAULIC
SYSTEMS FOR
BRIDGE
CONSTRUCTION
AND
REPAIRS**

NSA Series





NSA Series

Single acting, load return
 Lock nut
 50 - 500 ton capacity
 100 - 250 mm stroke
 Totally 32 models
 700 bar maximum operating pressure

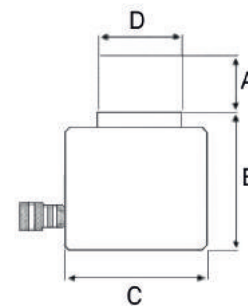

Model No.	Capacity	A	B	C	D	Effective Area	Oil Capacity	Weight
		Stroke	Closed Height	Outside Diameter	Rod Diameter			
	ton	mm	mm	mm	mm	cm ²	cm ³	kg
NSA-5010	50	100	240	138	85	70,88	709	28,0
NSA-5015		150	290				1063	33,5
NSA-5020		200	340				1418	39,0
NSA-5025		250	390				1772	44,5
NSA-10010	100	100	270	185	120	143,14	1432	54,5
NSA-10015		150	320				2147	64,0
NSA-10020		200	370				2863	73,5
NSA-10025		250	420				3588	83,0
NSA-15010	150	100	293	225	150	213,82	2138	88,0
NSA-15015		150	343				3207	102,0
NSA-15020		200	393				4276	116,0
NSA-15025		250	443				5345	130,0
NSA-20010	200	100	308	255	170	283,53	2835	118,0
NSA-20015		150	358				4253	135,0
NSA-20020		200	408				5671	153,0
NSA-20025		250	458				7088	170,5
NSA-25010	250	100	327	290	195	363,05	3631	164,0
NSA-25015		150	377				5446	187,5
NSA-25020		200	427				7261	211,0
NSA-25025		250	477				9076	234,5
NSA-30010	300	100	348	320	210	433,74	4337	211,5
NSA-30015		150	398				6506	239,0
NSA-30020		200	448				8675	266,5
NSA-30025		250	498				10844	294,0
NSA-40010	400	100	398	380	245	572,56	5726	345,0
NSA-40015		150	448				8588	385,5
NSA-40020		200	498				11451	426,0
NSA-40025		250	548				14314	466,5
NSA-50010	500	100	427	420	275	706,86	7069	454,0
NSA-50015		150	477				10603	504,0
NSA-50020		200	527				14137	554,0
NSA-50025		250	577				17672	604,0

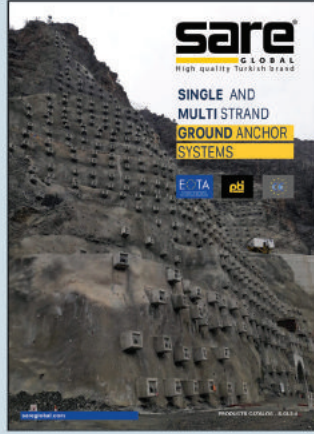
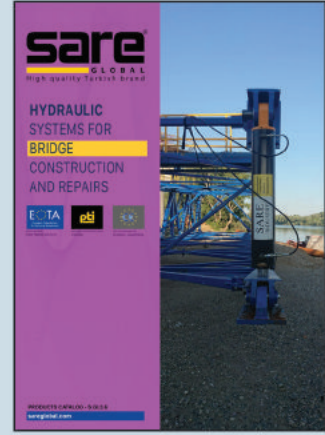

sare[®]
GLOBAL
High Quality Turkish Brand

Merkez Mah. Çavuşbaşı Cad. No.42 D.5-8 Çekmeköy 34782 İstanbul - Türkiye
P: +90 216 313 11 13 pbx
info@sareglobal.com • www.sareglobal.com

