

**sare**<sup>®</sup>  
GLOBAL  
High quality Turkish brand

# DATA SHEET



## DA Series

Double acting  
Hydraulic return  
30-100 ton capacity  
100-350 mm stroke  
Totally 30 models



HYDRAULIC  
SYSTEMS FOR  
BRIDGE  
CONSTRUCTION  
AND  
REPAIRS

DA Series





## DA Series

Double acting  
Hydraulic return  
30 - 100 ton capacity  
100 - 350 mm stroke  
Totally 30 models  
700 bar maximum  
operating pressure

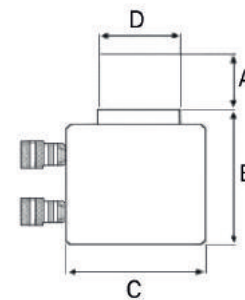

Model No.	Capacity	A	B	C	D	Effective Area	Oil Capacity	Weight
	ton	Stroke mm	Closed Height mm	Outside Diameter mm	Rod Diameter mm			
DA-3010	30	100	255	112	60	44,18	283	18,0
DA-3015		150	305				425	21,5
DA-3020		200	355				567	25,0
DA-3025		250	405				714	28,5
DA-3030		300	455				861	31,5
DA-3035		350	505				1008	35,0
DA-3040		400	555				1155	38,5
DA-5010	50	100	260	139	75	70,88	442	28,0
DA-5015		150	310				663	33,0
DA-5020		200	360				884	38,0
DA-5025		250	410				1105	43,0
DA-5030		300	460				1326	48,0
DA-5035		350	510				1547	53,0
DA-5040		400	560				1768	58,0
DA-5050	500	660	2210	68,0				
DA-7510	75	100	265	161	90	103,87	637	36,5
DA-7515		150	315				956	43,0
DA-7520		200	365				1275	49,5
DA-7525		250	415				1594	56,0
DA-7530		300	465				1913	62,5
DA-7535		350	515				2232	69,0
DA-7540		400	565				2551	75,0
DA-7550	500	665	3188	88,5				
DA-10010	100	100	275	188	100	143,14	785	50,5
DA-10015		150	325				1177	59,0
DA-10020		200	375				1569	67,5
DA-10025		250	425				1961	76,0
DA-10030		300	475				2353	84,5
DA-10035		350	525				2745	93,0
DA-10040		400	575				3137	101,5

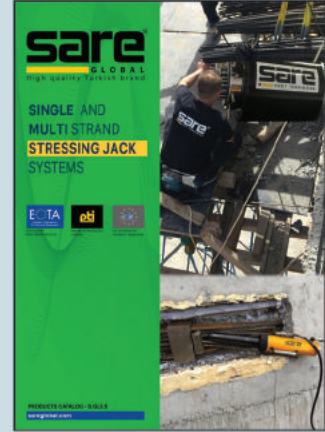
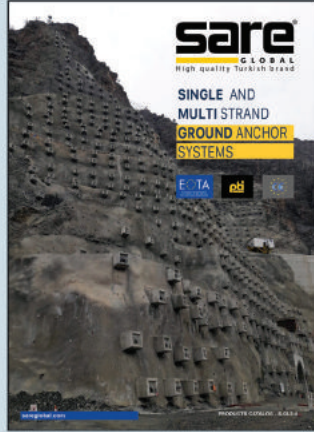
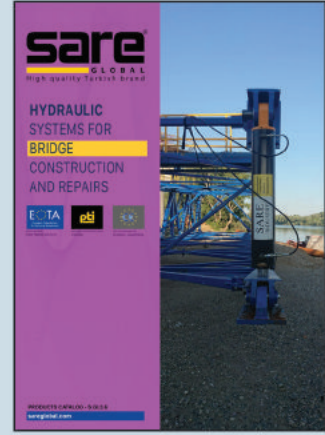

**sare**<sup>®</sup>  
GLOBAL  
High Quality Turkish Brand

Merkez Mah. Çavuşbaşı Cad. No.42 D.5-8 Çekmeköy 34782 İstanbul - Türkiye  
P: +90 216 313 11 13 pbx  
info@sareglobal.com • www.sareglobal.com

