

sare[®]
GLOBAL
High quality Turkish brand

DATA SHEET



**Hollow
Jacks**

CH Series

Double acting
Hydraulic return
30-100 ton capacity
50-350 mm stroke
Totally 35 models



**HYDRAULIC
SYSTEMS FOR
BRIDGE
CONSTRUCTION
AND
REPAIRS**

CH Series





CH Series

Double acting
Hydraulic return
Center hole
30 - 100 ton capacity
50 - 350 mm stroke
Totally 35 models

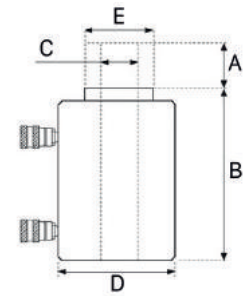

Model No.	Capacity	A	B	C	D	Effective Area	Oil Capacity	Weight
		Stroke	Closed Height	Outside Diameter	Rod Diameter			
	ton	mm	mm	mm	mm	cm ²	cm ³	kg
CH-305/33	30	50	134	33	133	43,96	123	12,5
CH-3010/33		100	185				245	16,3
CH-3015/33		150	290				368	29,0
CH-3020/33		200	340				490	33,5
CH-3025/33		250	390				615	38,0
CH-3030/33		300	440				736	42,5
CH-3035/33		350	490				858	47,0
CH-505/33	50	50	136	33	155	75,36	220	19,0
CH-5010/33		100	186				440	25,0
CH-5015/33		150	290				660	37,0
CH-5020/33		200	340				880	43,0
CH-5025/33		250	390				1100	49,0
CH-5030/33		300	440				1320	55,0
CH-5035/33		350	490				1540	61,0
CH-605/54	60	50	146	54	173	84,2	240	23,0
CH-6010/54		100	196				480	30,0
CH-6015/54		150	292				720	43,0
CH-6020/54		200	342				960	50,0
CH-6025/54		250	392				1200	57,0
CH-6030/54		300	442				1440	64,0
CH-6035/54		350	492				1680	71,0
CH-805/60	80	50	151	60	194	114,8	314	30,0
CH-8010/60		100	201				628	38,5
CH-8015/60		150	300				942	55,0
CH-8020/60		200	350				1256	63,5
CH-8025/60		250	400				1570	72,0
CH-8030/60		300	450				1884	80,5
CH-8035/60		350	500				2198	89,0
CH-1005/65	100	50	155	65	212	144,24	380	36,5
CH-10010/65		100	205				760	46,5
CH-10015/65		150	310				1140	68,5
CH-10020/65		200	360				1520	79,0
CH-10025/65		250	410				1860	89,0
CH-10030/65		300	460				2200	99,0
CH-10035/65		350	510				2540	109,0

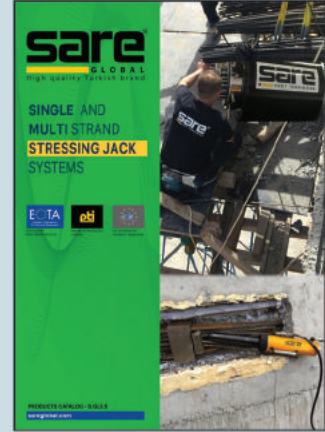
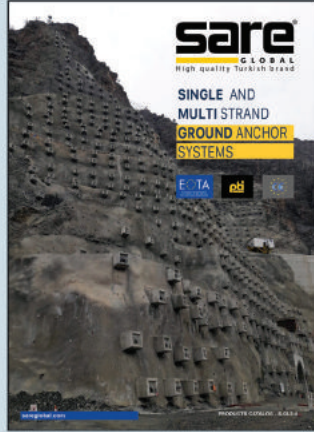
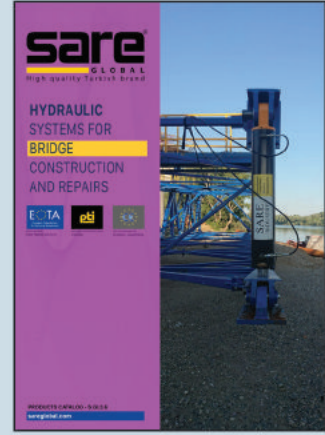

sare[®]
GLOBAL
High Quality Turkish Brand

Merkez Mah. Çavuşbaşı Cad. No.42 D.5-8 Çekmeköy 34782 İstanbul - Türkiye
P: +90 216 313 11 13 pbx
info@sareglobal.com • www.sareglobal.com

